

## Electronic devices

1. Fill in the missing letters to make electronic items.

1. m o u s e
2. r \_ m \_ t \_
3. t \_ bl \_ t
4. c \_ m \_ r \_
5. ch \_ rg \_ r
6. b \_ tt \_ ry
7. l \_ pt \_ p
8. sp \_ \_ k \_ rs
9. fl \_ sh dr \_ v \_
10. g \_ m \_ c \_ ns \_ le

2. Write words 1–8 from Exercise 1 in the puzzle.

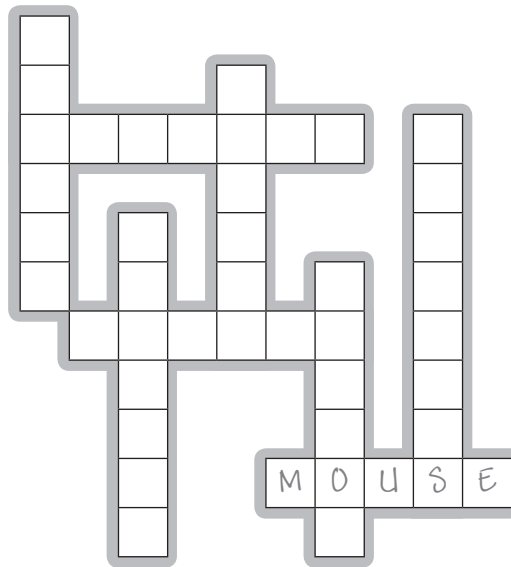

## Using electronic devices

3. Look at the pictures. Write the correct words. Use the words below.

charge connect disconnect download plug in replace turn off turn on unplug upload



1. connect



2. \_\_\_\_\_

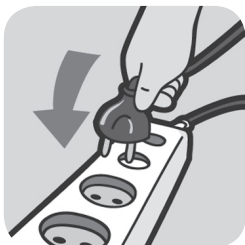

3. \_\_\_\_\_

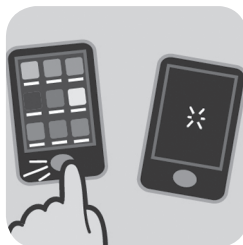

4. \_\_\_\_\_



5. \_\_\_\_\_



6. \_\_\_\_\_



7. \_\_\_\_\_



8. \_\_\_\_\_



9. \_\_\_\_\_



10. \_\_\_\_\_

4. Complete the statements. Use the correct form of some of the verbs from Exercise 3.

1. You need to plug in your tablet to charge the battery.
2. My phone isn't working. I need to \_\_\_\_\_ the batteries with new ones.
3. "Do you \_\_\_\_\_ a lot of music and video from the internet?"  
"Not really. But I sometimes \_\_\_\_\_ photos to my blog."
4. It's late! \_\_\_\_\_ that laptop and go to bed.
5. The first thing I do in the morning is \_\_\_\_\_ my computer and \_\_\_\_\_ to the internet.